

Section 106 Consulting Parties Meeting #13 for the Washington Union Station Expansion Project

January 31, 2023

Meeting Purpose:

1. Discuss the effect assessments and determinations to historic properties documented in the Supplemental Assessment of Effects (SAOE) Report
2. Discuss proposed minimization and mitigation measures, which will be recorded in the Programmatic Agreement (PA)

NEPA & Section 106 Processes

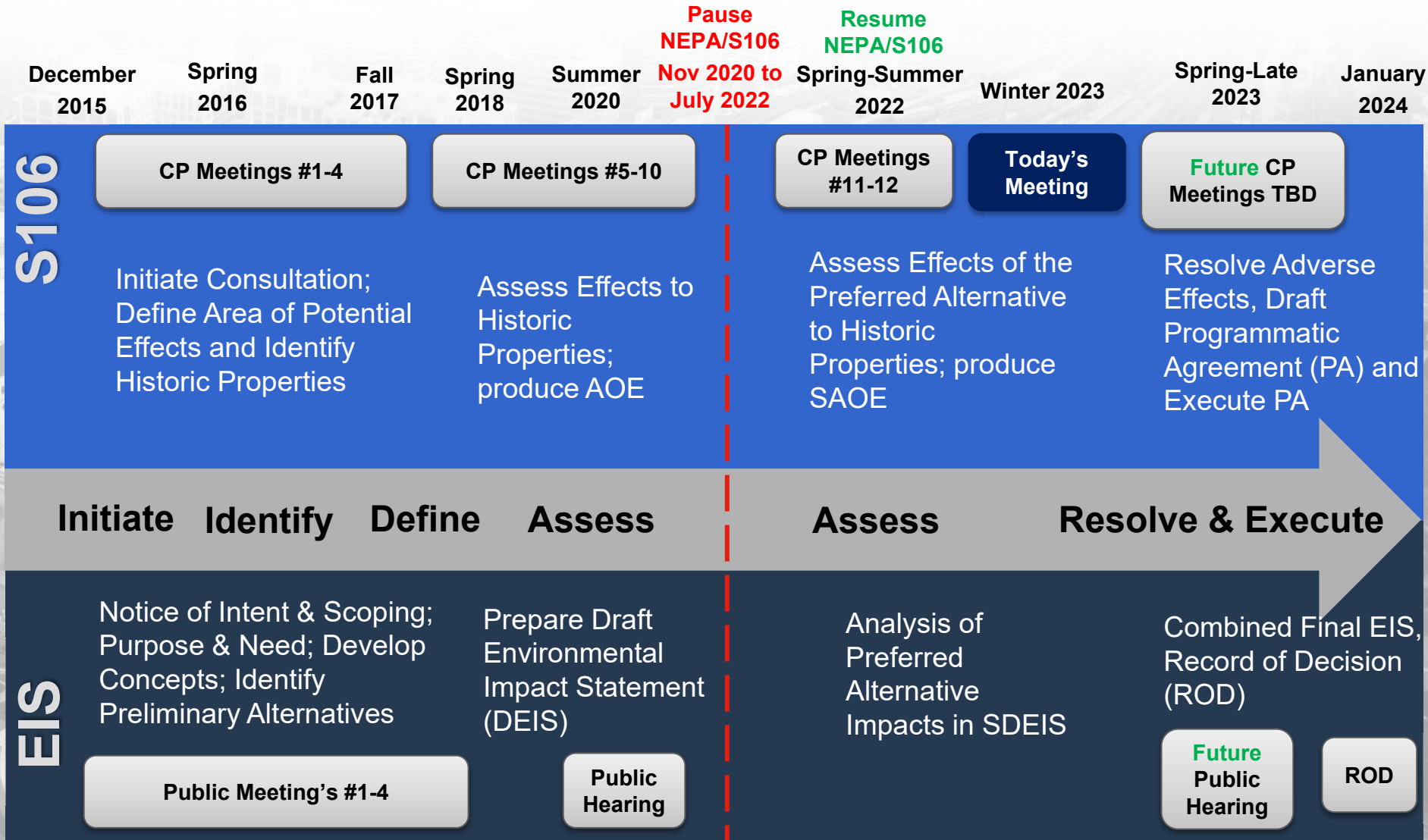

Effects of the Preferred Alternative to Historic Properties



Preferred Alternative

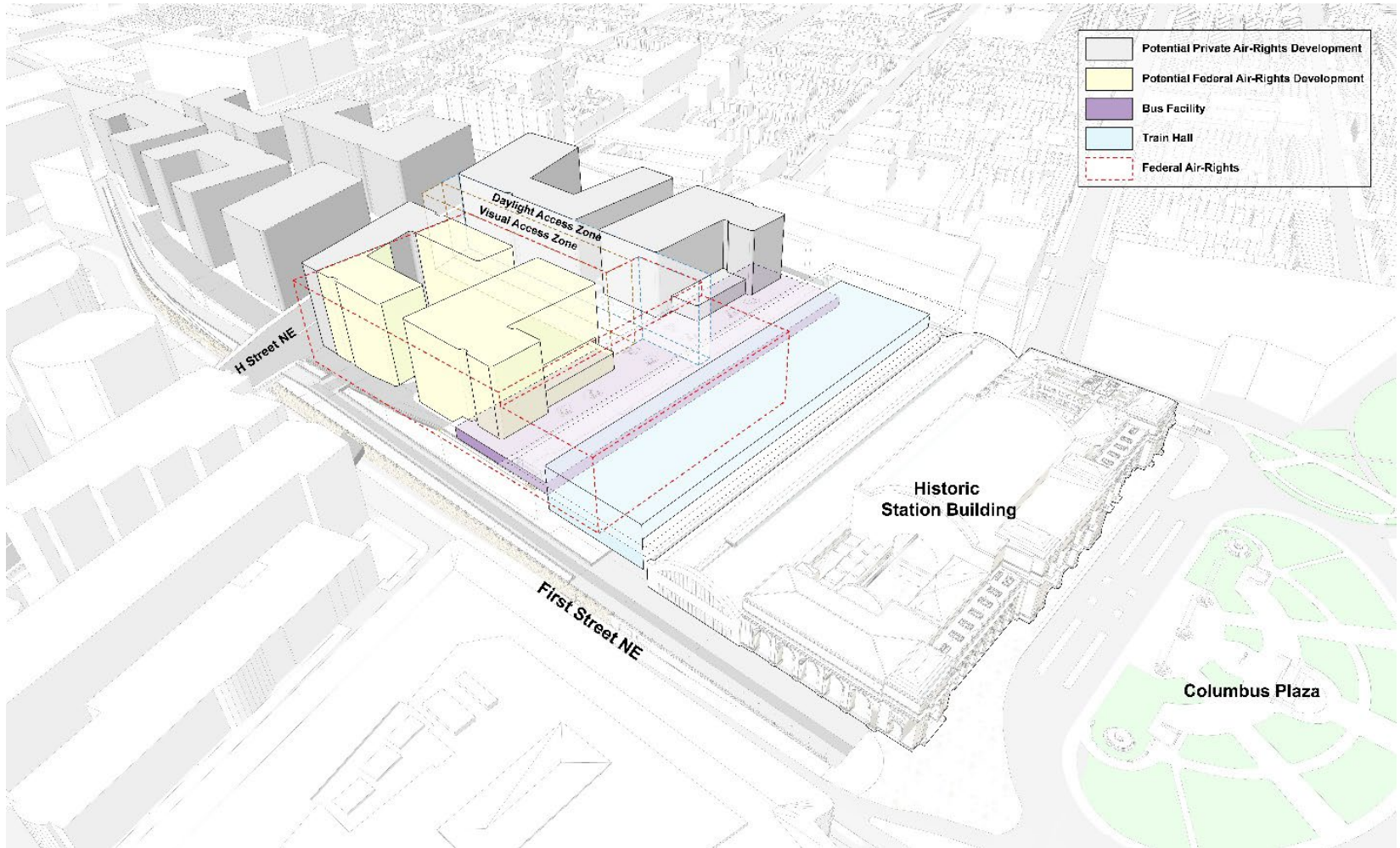

Preferred Alternative

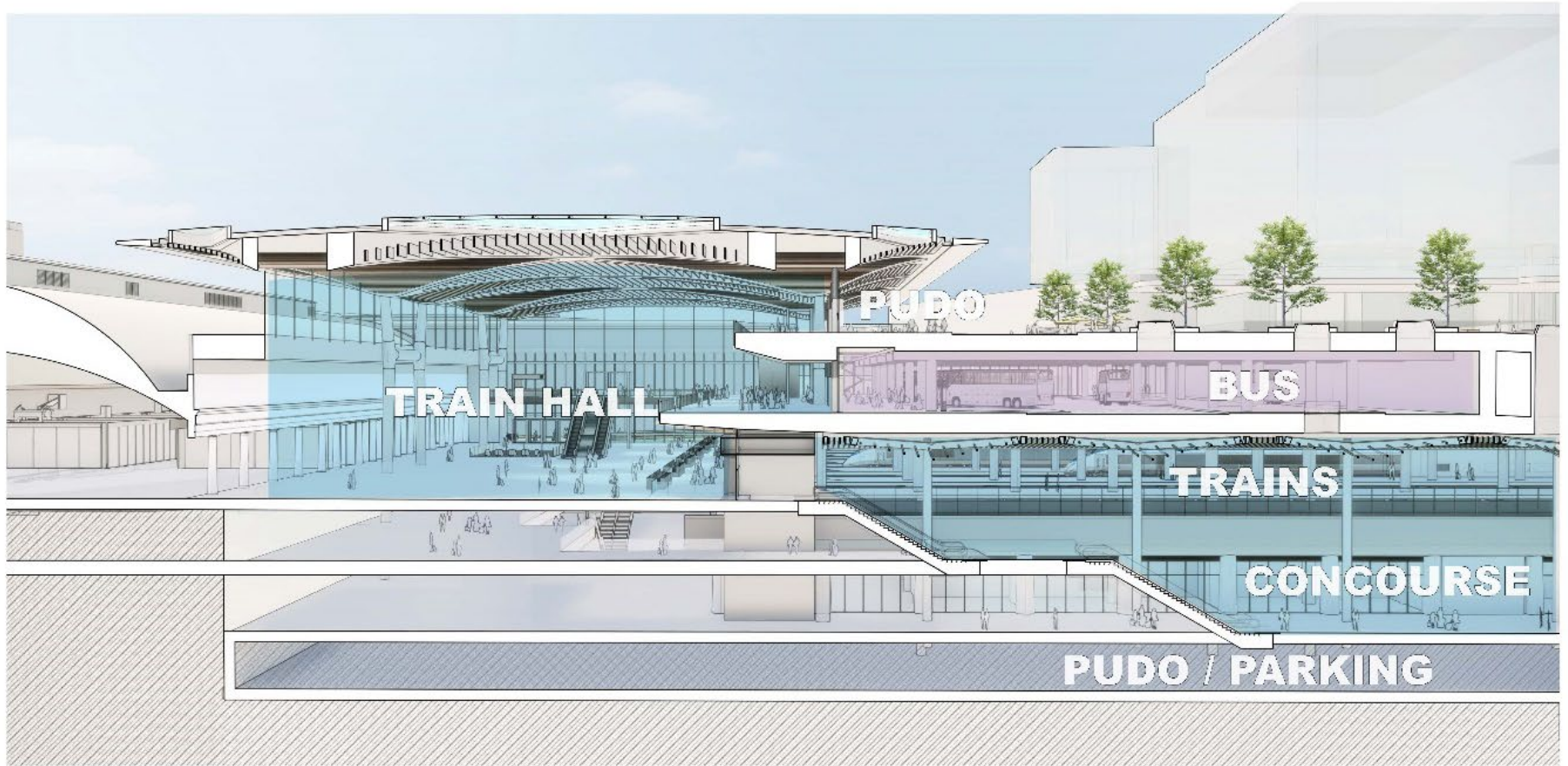

Plan and Neighborhood Context

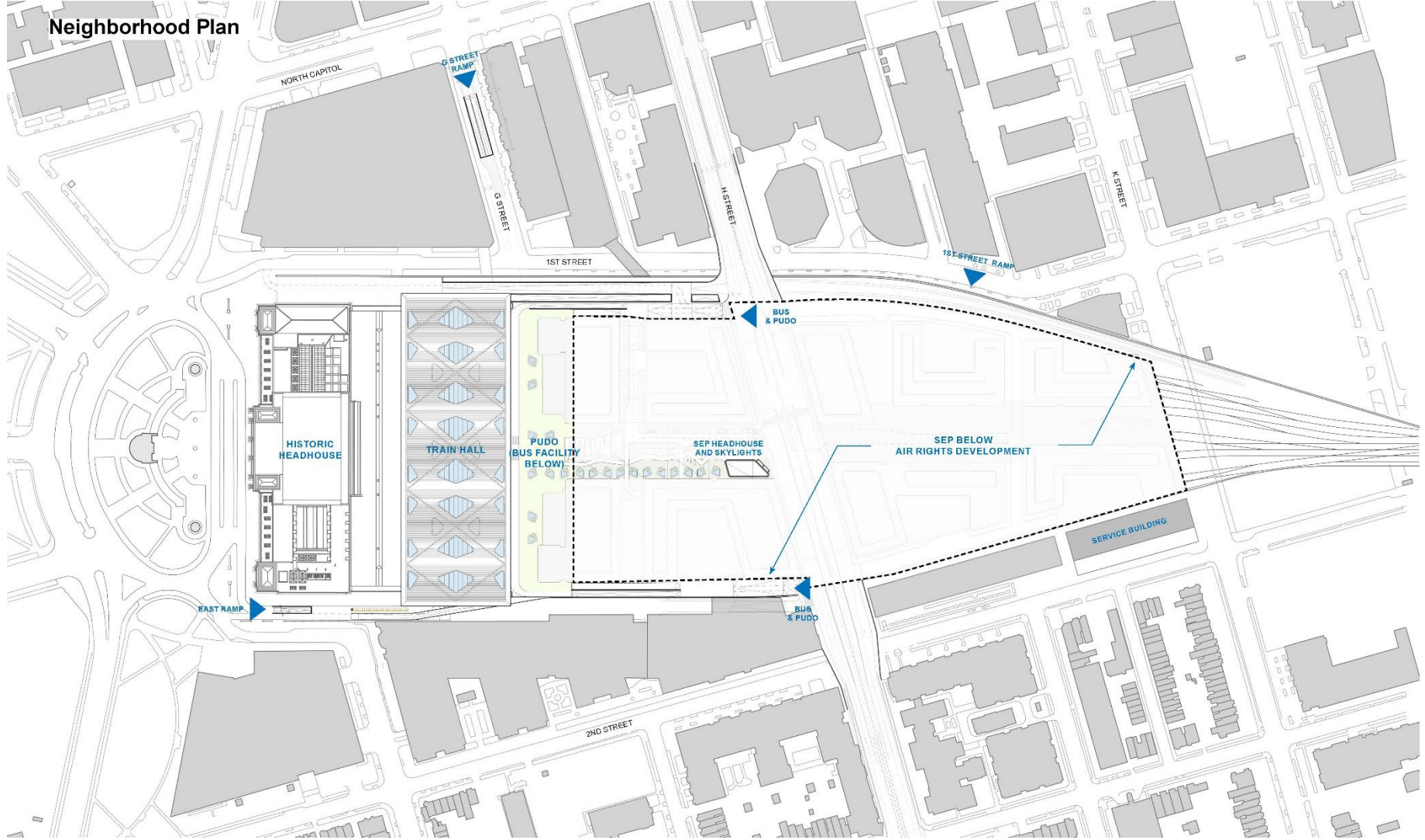

Types of Effects Analyzed

FRA assessed the effects of the Preferred Alternative against existing conditions.

Types of direct and indirect effects considered:

- Physical
- Visual
- Noise
- Vibration
- Traffic
- Cumulative



Summary of Effects

Finding of Adverse Effect

1. Washington Union Station (WUS)
2. WUS Historic Site
3. Railway Express Agency (REA) Building

Finding of Potential Adverse Effect

1. City Post Office (Postal Museum)*

* Different determination from that presented in the draft AOE

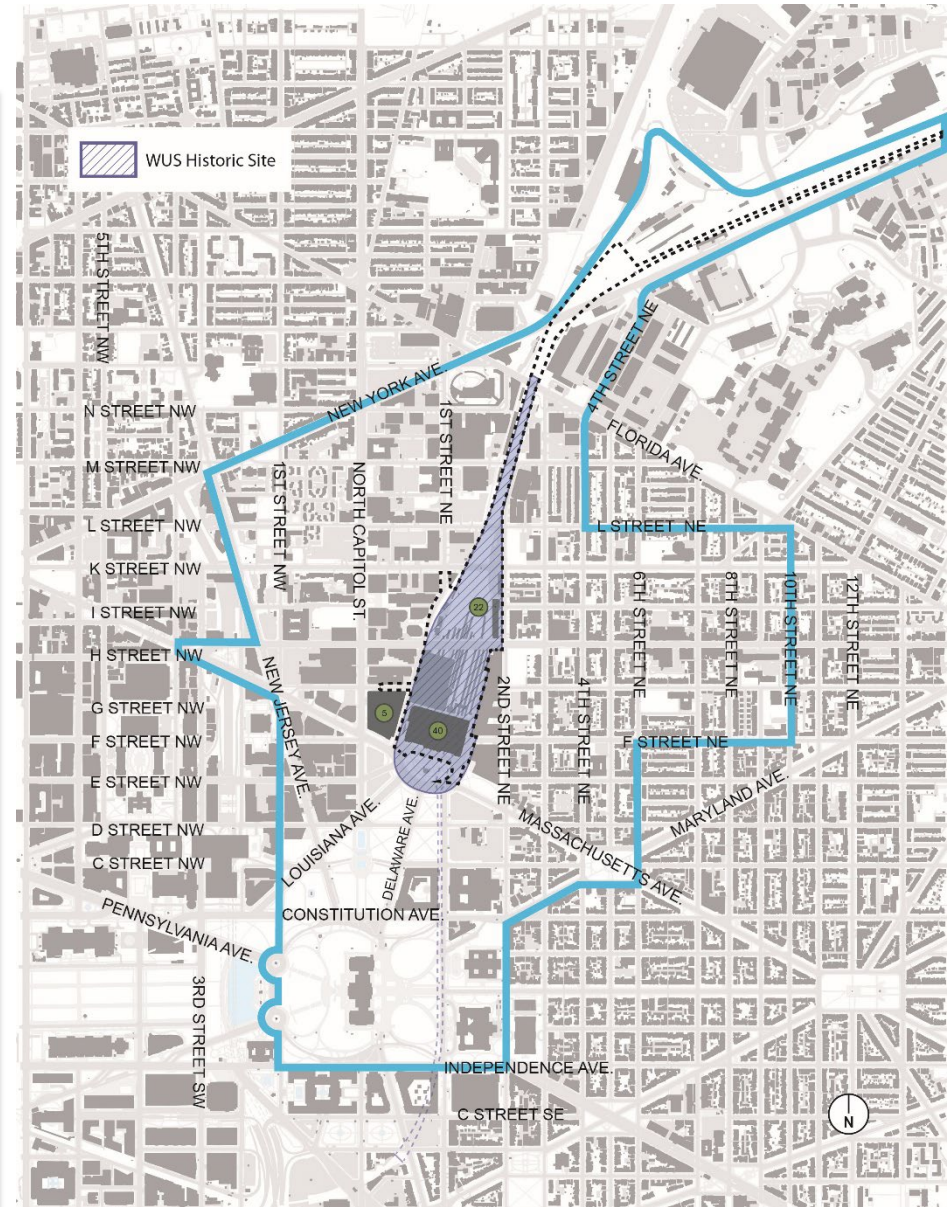

Finding of No Adverse Effect

1. C&P Telephone Company Warehouse
2. Dirksen and Hart Senate Office Buildings
3. Government Printing Office
4. Government Printing Office Warehouse No.4
5. Holodomor Ukrainian Holocaust Memorial
6. **Joseph Gales School***
7. Library of Congress, Jefferson Building
8. Russell Senate Office Building
9. Senate Parks, Garage, and Fountains
10. Square 750 Rowhouse Development
11. St. Aloysius Catholic Church
12. St. Joseph's Home (Former)
13. St. Philip's Baptist Church
14. Suntrust Building (Former Childs Restaurant)
15. Thurgood Marshall Judiciary Building
16. Tophams Luggage Factory (Former)
17. Uline Arena Complex
18. Columbus Plaza
19. Woodward and Lothrop Service Warehouse
20. 901 Second Street
21. **Capitol Hill Historic District***
22. L'Enfant – McMillan Plan
23. View from the U.S. Capitol Dome
24. View from the Washington Monument

* *Different determination from the draft AOE*



Capitol Hill Historic District – No Adverse Effect

- **Physical effects** ✘ No direct physical effects
- **Visual effects** ✔ would not adversely affect significance or integrity
- **Noise & Vibration effects** ✔ would not adversely affect significance or integrity
- **Traffic effects** ✔ would not adversely affect significance or integrity



*View looking northeast along F St NE
from 3rd St NE*

Capitol Hill Historic District – No Adverse Effect

Traffic modeling for the Preferred Alternative shows reduced traffic impacts to the historic district compared to the previous Action Alternatives assessed in the draft AOE. This is due to the following:

- Reductions in parking, introduction of belowground facility, and multimodal access improvements resulted in mode shift away from cars.
- Removal of vehicular ramp from the deck level to F Street NE on the east side of WUS that directed some vehicular traffic toward the historic district.
- Dedicated PUDO areas in the belowground facility. The access to the belowground facility is from the west (at ramps located at First Street NE and G Street NE).
- Relocation of bus access to permit both east and westbound movements onto the H Street Bridge.

Washington Union Station – Adverse Effect

- **Physical effects** ✓
 - **adverse** effect
- **Visual effects** ✓
 - **adverse** effect
- **Noise & Vibration effects** ✓
 - **potential adverse** effect
- **Traffic effects** ✓ would not adversely affect significance or integrity



WUS, looking northwest



1919 photo (Library of Congress)

WUS Historic Site – Adverse Effect

- **Physical effects** ✓
 - **adverse** effect
- **Visual effects** ✓
 - **adverse** effect
- **Noise & Vibration effects** ✓
 - **potential adverse** effect to WUS and the REA Building
- **Traffic effects** ✓ would not adversely affect significance or integrity



Aerial view of WUS Historic Site

REA Building – Adverse Effect

- **Physical effects** ✓
 - **adverse** effect
- **Visual effects** ✓
 - **adverse** effect
- **Noise & Vibration effects** ✓
 - **potential adverse** effect
- **Traffic effects** ✓ would not adversely affect significance or integrity



REA Building east elevation

City Post Office (Postal Museum) – Potential Adverse Effect

- **Physical effects** ✘ No physical effects
- **Visual effects** ✔ would not adversely affect significance or integrity
- **Noise & Vibration effects** ✔
 - Temporary vibration effects have the **potential** to result in an **adverse** effect
- **Traffic effects** ✔ would not adversely affect significance or integrity



City Post Office south elevation



City Post Office north elevation, looking east



Proposed Minimization and Mitigation of Adverse and Potential Adverse Effects

Programmatic Agreement – General Outline

1. **Title** – Identifies the Project and the PA's signatories
2. **Preamble** –
 - Defines the Project
 - Provides relevant background and summarizes the Section 106 decisions of the Project
 - Identifies the agencies and parties involved in the Section 106 consultation
3. **Stipulations** –
 - Roles and responsibilities of the Signatories
 - Avoidance, minimization, and/or mitigation measures the sponsor(s) will implement
 - Unanticipated discoveries and emergency-situation protocols
 - Public involvement
 - Dispute resolution
 - Duration, amendment, and termination

Minimization and Mitigation Considered

- Development and implementation of monitoring plans including
 - Vibration monitoring during construction for WUS, the REA Building, and the City Post Office
 - Archaeological monitoring during the excavation of the rail terminal and sections of street impacted by the construction of the vehicular ramps
- Continued coordination to study, identify, and monitor traffic in the study area and work to avoid, minimize or resolve traffic congestion. The PA will acknowledge that mitigation measures will be developed in the context of NEPA, including
 - Policies and infrastructure to control traffic access
 - Developing and implementing a construction noise and vibration control plan

Minimization and Mitigation Considered

- Continued coordination to develop design guidelines and a review process for the future transfer and redevelopment of the Federal air-rights property
- Continued design coordination to ensure that the Secretary of the Interior's Standards are adhered to
- Historic American Buildings Survey / Historic American Engineering Record documentation of elements that would be removed or demolished
- Salvage certain elements and materials that would require removal
- Develop public interpretation displays for the adversely affected historic properties



Next Steps



Planned Section 106 Consultation

Winter 2023:

Final determination of effect submitted to SHPO

- Adverse Effect Notice to ACHP

Spring/Summer 2023:

- Draft PA available for public review and comment (included in the Supplemental Draft Environmental Impact Statement [SDEIS])
- CP Meeting #14 to further discuss draft PA

Late 2023/Early 2024:

- Finalize and execute PA prior to Record of Decision (ROD)

General Discussion





THANK YOU

Amanda Murphy

Acting Federal Preservation
Officer

Federal Railroad Administration
amanda.murphy2@dot.gov

Project website:

www.WUSstationexpansion.com

