

2015 FRA Rail Program Delivery



California High-Speed Rail: Handling the Real Estate Challenge

Todd McIntyre - FRA

Marian Rule - TranSystems



CHSRA Program Overview

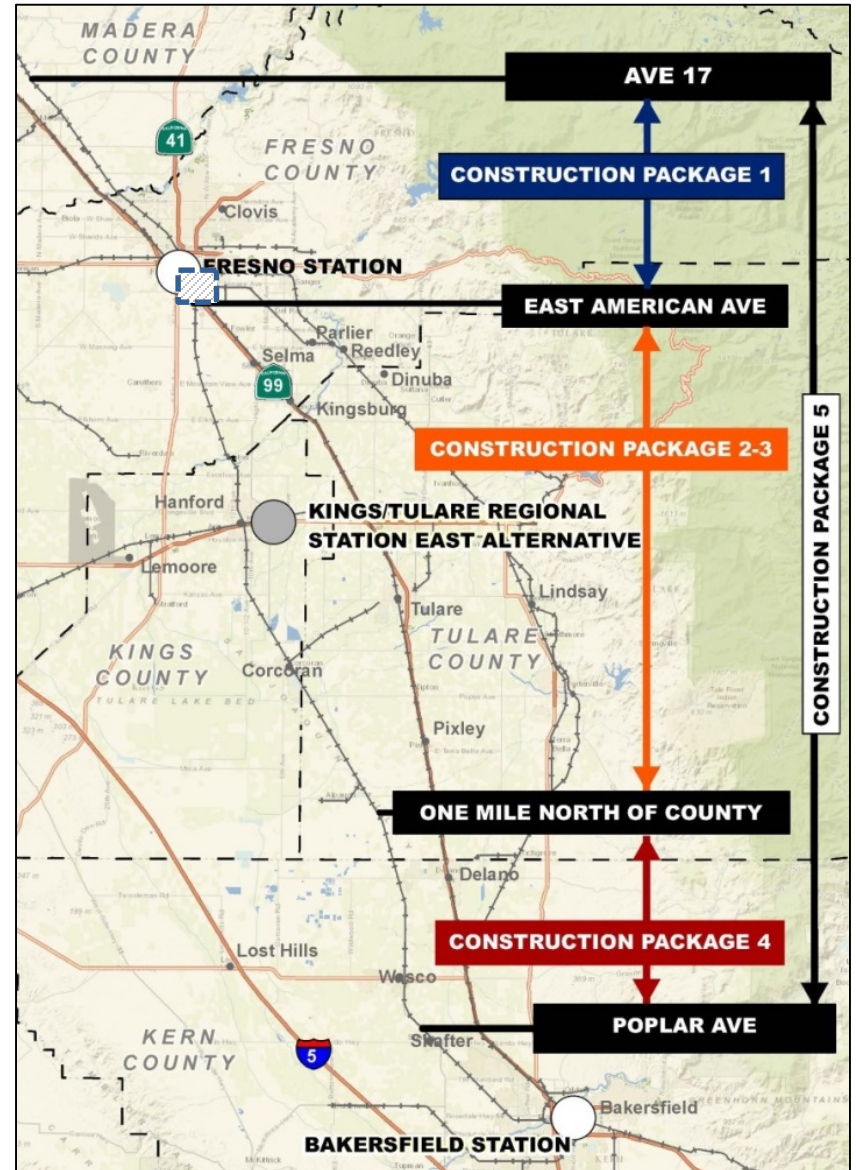
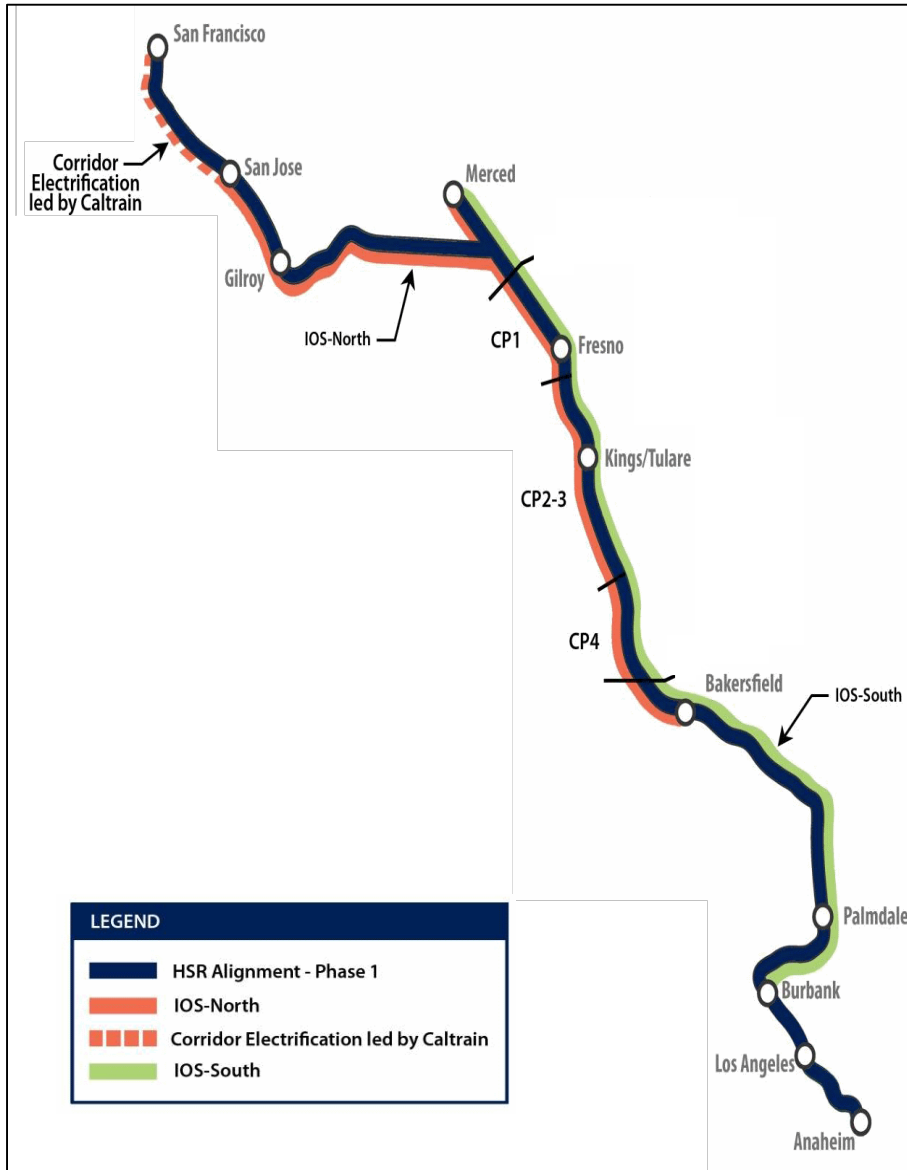

CHSRA Real Estate Acquisition Scope

- ❑ Uses:
 - ❑ Agricultural, Residential, Commercial, Industrial, Public Use
- ❑ Occupancy:
 - ❑ Some Vacant, some requiring relocation [Uniform Relocation Act (URA)]
- ❑ Ownership:
 - ❑ Some publically owned, some privately owned



Right-of-Way to be Acquired		
Section	# of Parcels	ROD
CP1AB	519 parcels	9/2012
CP1C	170 parcels	9/2012
CP2-3	543 parcels	6/27/2014
CP4AB	226 parcels	6/27/2014
Total	1458 parcels	

FRA / CHSRA Partnership

- ❑ Real Estate Reviews in 2013 and 2015
- ❑ Acquisition Date Forecasting
- ❑ URA technical assistance
- ❑ GIS, analytics and metrics

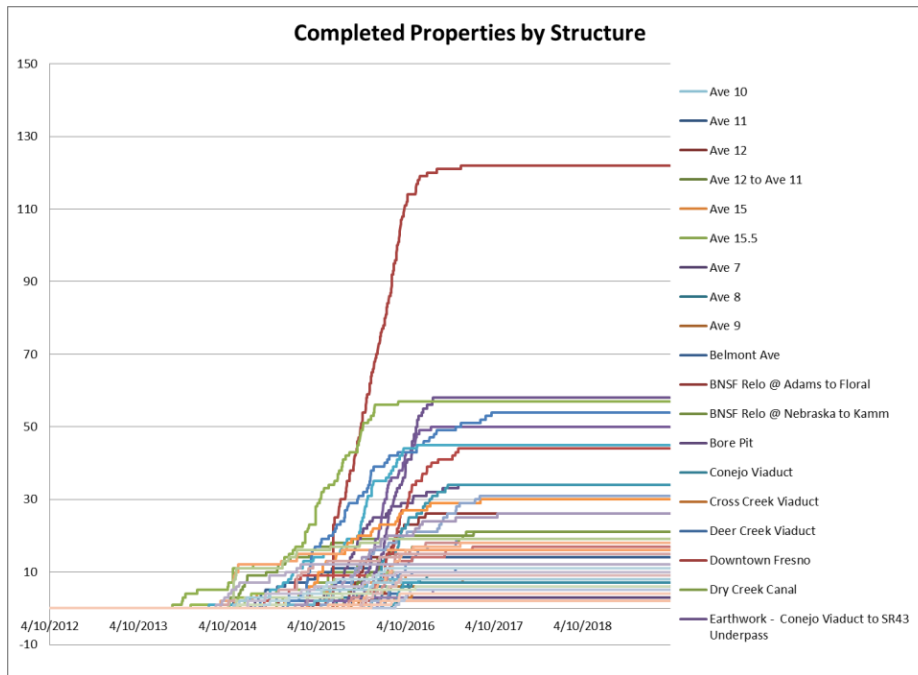
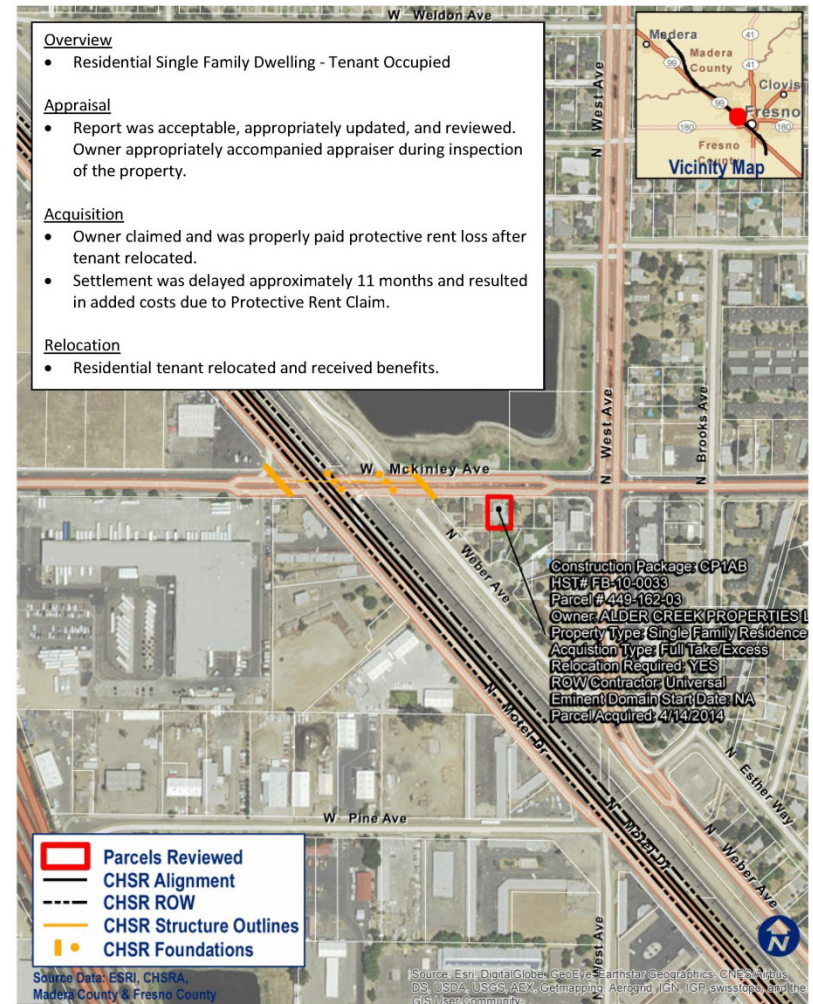

Evolution of the Process and Team

- ❑ Define roles and responsibilities
- ❑ Define procedures
 - ❑ ROW Acquisition Plan
- ❑ Define process and timelines
- ❑ Monitor, adjust and refine

Strategy for Approach

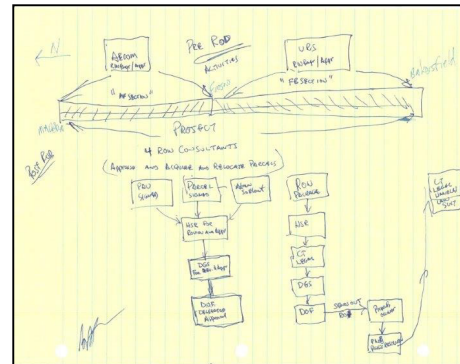

2013/2014 Process Flow

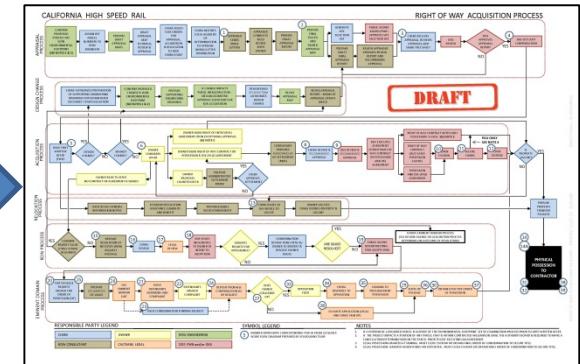

2015 Process Flow

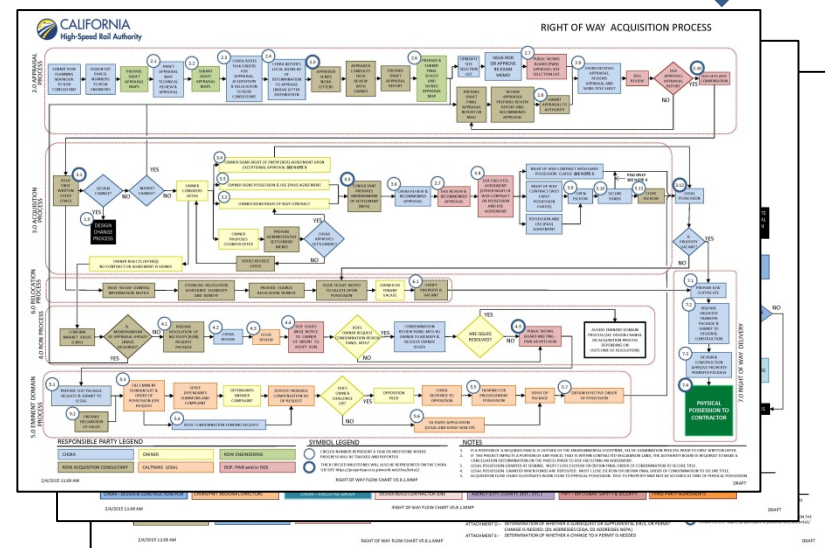

Poised for Performance

- ❑ Establish team organization and resources
- ❑ Define process and lay out method of data collection
- ❑ Proceed with a corridor-wide, big-picture approach
- ❑ Identify challenge areas and take action:
 - ❑ Use strike teams to reduce number of properties for condemnation
 - ❑ Analyze data to address problem areas and refine process
 - ❑ Early start on relocations
 - ❑ No lapsed time between steps
 - ❑ Tracking owners' development plans
- ❑ Maximize use of Consultant teams
 - ❑ Delegate responsibility to field level when possible
 - ❑ Maintain focus on training and quality to minimize rework

Thank You

Todd McIntyre

Western Region Lead

FRA-RPD

Todd.McIntyre@dot.gov

(202) 493-0413

&

Alan Glen

Director of Real Property

CHSRA

Alan.Glen@HSR.ca.gov

(916) 330-5668

